

## Панта Estebro® за заваряване кръгла двукрила, дясна с лагер 20x150x3 мм, 611

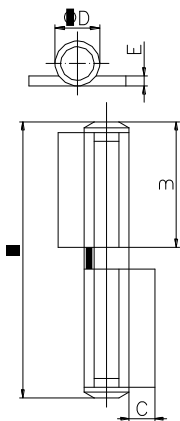

Cod	Dimens.	A	B	C	∅D	E	W	H
608	18x110x3 Izda Esquerda-Left- Gauche	112	51	17	18	3	12	3,20
609	18x110x3 Dcha Direita-	112	51	17	18	3	12	3,20
610	20x150x3 Izda Esquerda-Left- Gauche	146	69	35	20	3	6	2,75
611	20x150x3 Dcha Direita- Right-Droite	146	69	35	20	3	6	2,75

**Family:** Flag hinges

**Material:** Bodies: Stainless steel AISI 304L Axle and end caps: Stainless steel AISI 303

**Maximum weight supported:** According to study

**Description:** Component which is installed on a metallic swing door to allows its opening and closing. The axial bearing installed between both bodies softens the maneuver turn. It has a fixed cap on each end which blocks the axle and prevents it from rusting. For the installation: the lower part is welded to the frame, that is why it is necessary to design it for the different hands (right/left), depending on the turn direction of the door.

Продукт: [Панта Estebro® за заваряване кръгла двукрила, дясна с лагер 20x150x3 мм, 611](#)

Категория: [Панти за заваряване](#)

Бранд: [Estebro®](#)

Категория бранд: [Панта Estebro®](#)